

GS2-DST

Group control relay

Technical specifications and installation instructions

Item number 60560

F-Con



1. Description

With the **GS2-DST group control relay**, two drives can be operated in parallel (e.g. for shades or windows) as a group with one control output. Cascading is possible (daisy-chaining multiple devices).

GS2-DST, for example, is suitable for the WS1 and WS1000 Colour and Style controllers and for the Solexa II wireless system.

1.0.1. Deliverables

- Group control relay GS2-DST
- Rubber seal

1.1. Technical Data

Housing	Plastic
Protection category *	IP 53
Housing dimensions	ca. 149 x 72 x 29 (W x H x D, mm)
Weight	ca. 215 g
Ambient temperature	Operation -20...+55°C, storage -30...+85°C
Operating voltage	230 V AC
Input	230 V AC, 50 Hz (Up/Down/N/PE). STAS3 plug
Output	2 x drive (STAK3 coupling), 230 V AC (Up/Down/N/PE), total load up to 4 A / 230 V AC

*The **Group control relay GS2-DST** should be installed in a protected area despite a high protection category because water can enter in via the connectors. Please observe the instructions in Chapter Connection.

The product conforms with the provisions of EU directives.

2. Installation and start-up

2.1. Installation notes



Installation, testing, operational start-up and troubleshooting should only be performed by an electrician.



DANGER! Risk to life from live voltage (mains voltage)!

There are unprotected live components within the device.

- VDE regulations and national regulations are to be followed.
- Ensure that all lines to be assembled are free of voltage and take precautions against accidental switching on.
- Do not use the device if it is damaged.
- Take the device or system out of service and secure it against unintentional use, if it can be assumed, that risk-free operation is no longer guaranteed.

The device is only to be used for the intended purpose described in this manual. Any improper modification or failure to follow the operating instructions voids any and all warranty and guarantee claims.

After unpacking the device, check it immediately for possible mechanical damage. If it has been damaged in transport, inform the supplier immediately.

The device may only be used as a fixed-site installation; that means only when assembled and after conclusion of all installation and operational start-up tasks and only in the surroundings designated for it.

Elsner Elektronik is not liable for any changes in norms and standards which may occur after publication of these operating instructions.

2.2. Connection

The group control relay is connected between the control wire and the consumer. It may only be connected to flexible lines using STAK/STAS connectors. Use the pro-

vided rubber seals between the STAK/STAS connectors. The connectors must be locked using the STASI locking bow.



Do not expose to continuous sun radiation to avoid overheating. The housing is not UV-resistant.



No water may run along the supply line and device.

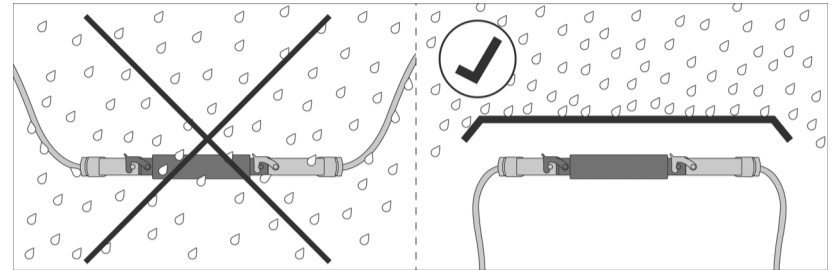

- Assemble the device in a protected area (e. g. in the box for the blinds/marquee/shutters in a construction profile beneath the roof tiles or in a housing).
- Lay the supply lines out and down from the device.



No vibrations!

- Assemble the device in a place that is free of vibrations.

2.2.1. Connection GS2-DST

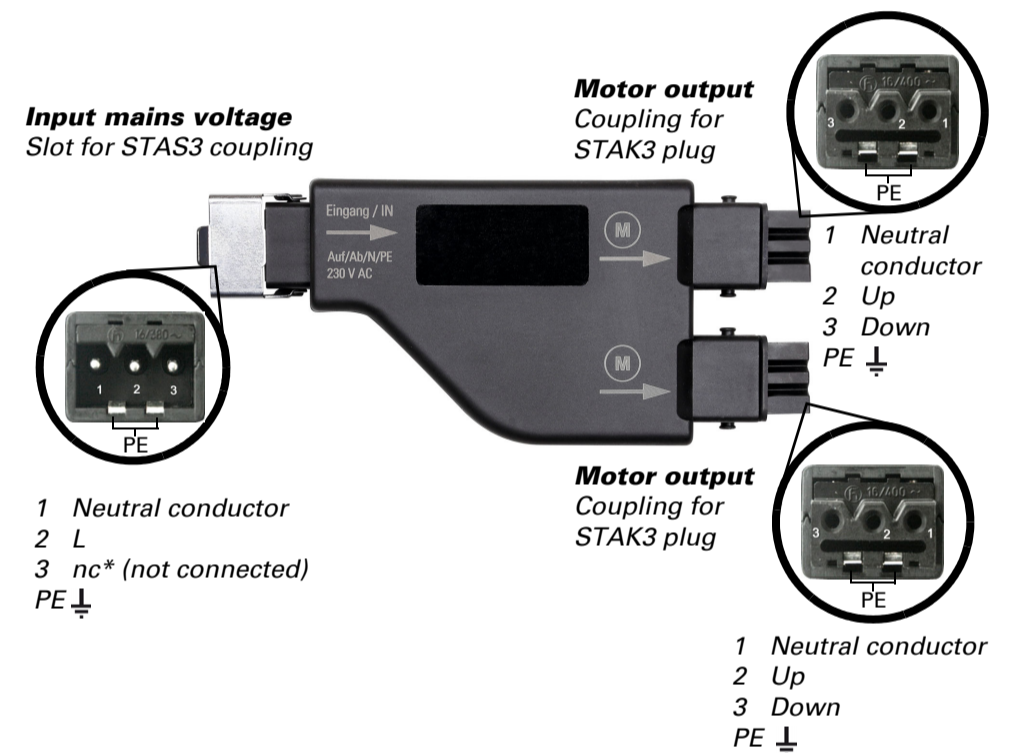

2.3. Notes on mounting and commissioning

Device must not be exposed to water (rain). This could result in the electronic being damaged. A relative air humidity of 95% must not be exceeded. Avoid bedewing.

2.4. Connection example

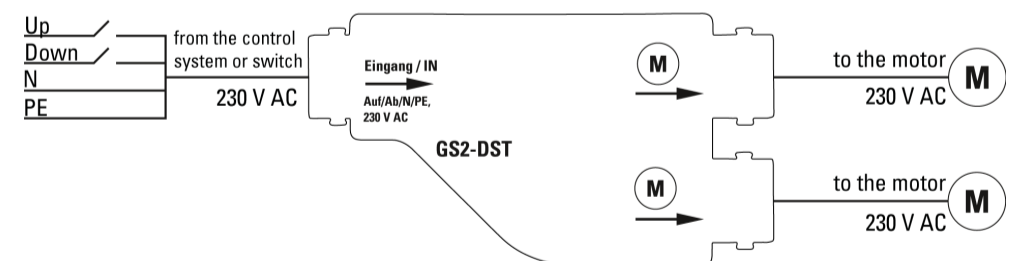

Mains connection wire and connection wires are available in different lengths as accessories.

Item numbers: Mains connection wire 60563 (5 m)

Connection wires 60565 (1 m), 60566 (2,5 m), 60567 (5 m)

3. Disposal

After use, the device must be disposed of or recycled in accordance with the legal regulations. Do not dispose of it with the household waste!